

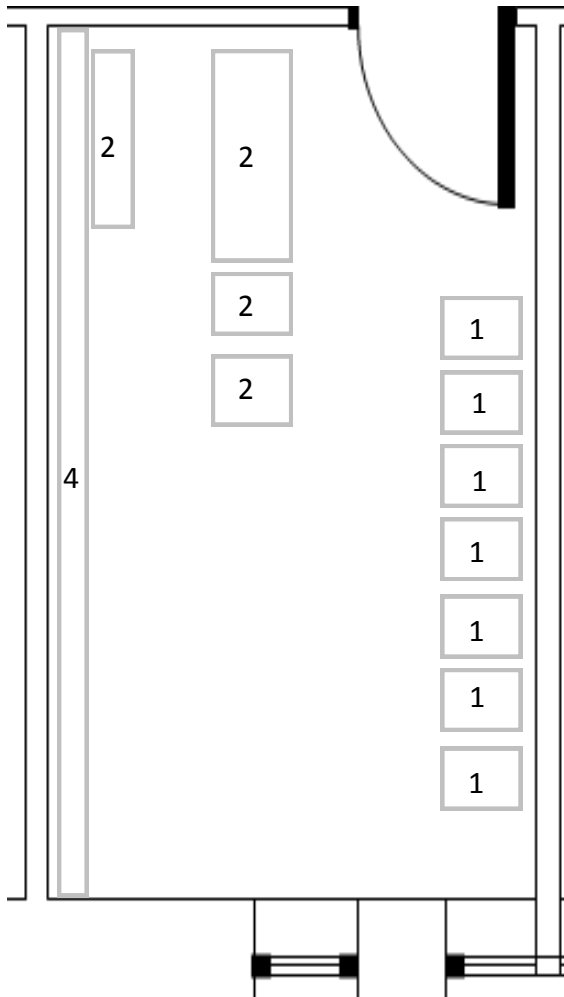

Dimensions: N/A

Times of use:  
8am—10pm

Fire Alarm test times:  
Weekly: Wednesday 2.30pm



1. Filing cabinet
2. Bookcase
3. Shelving for scores

Equipment & Furniture

N/A

Important Information.

No food or drink is allowed anywhere in the Music Block.  
Capped bottles of water are permitted.

Loud, amplified rehearsals may only take place after 5pm with  
the windows closed.

Only musical equipment on the room equipment list should be  
left in the room after each session.