



Dimensions: N/A

Times of use:

Mon-Thurs 9:00am-5:00pm
Fri: 9:00am-4:30pm

Fire Alarm test times:

Weekly: Wednesday 2:30pm

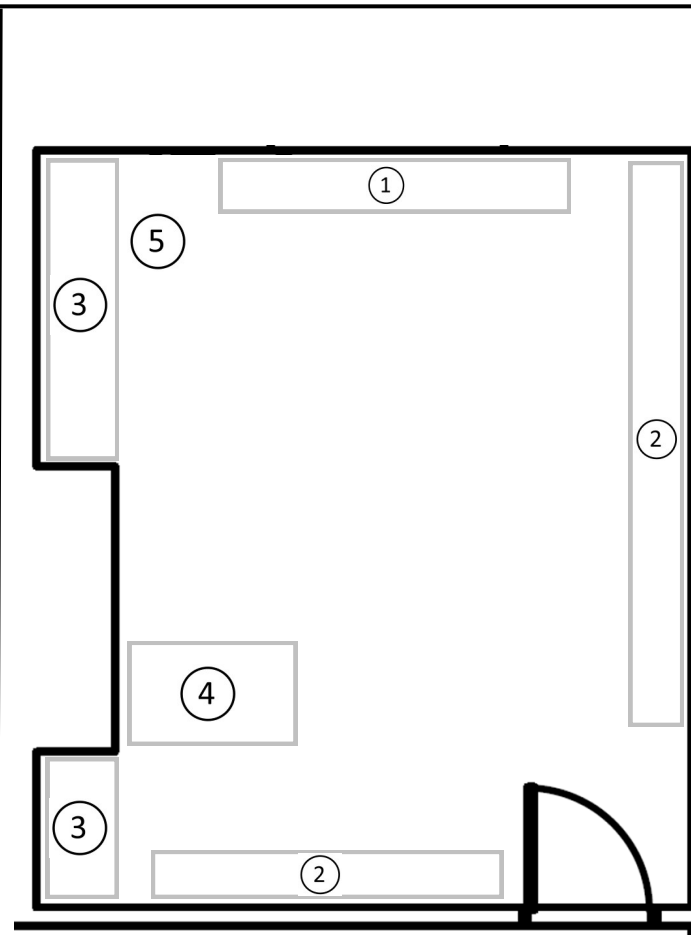

1. Portable clothes rail
2. Fixed clothes rail
3. Storage cupboard
4. Work bench
5. Shoe rack

Equipment & Furniture

- | | |
|-----|---|
| 1 x | Portable clothes rail |
| 2 x | Fixed clothes rail |
| 2 x | Storage cupboard
- Sewing machines
- Irons
- Miscellaneous |
| 1 x | Work bench |
| 1 x | Shoe rack |

Important Information.

No food or drink is allowed anywhere in the performance spaces. Capped bottles of water are permitted.

Only equipment on the room equipment list should be left in the room after each session.