

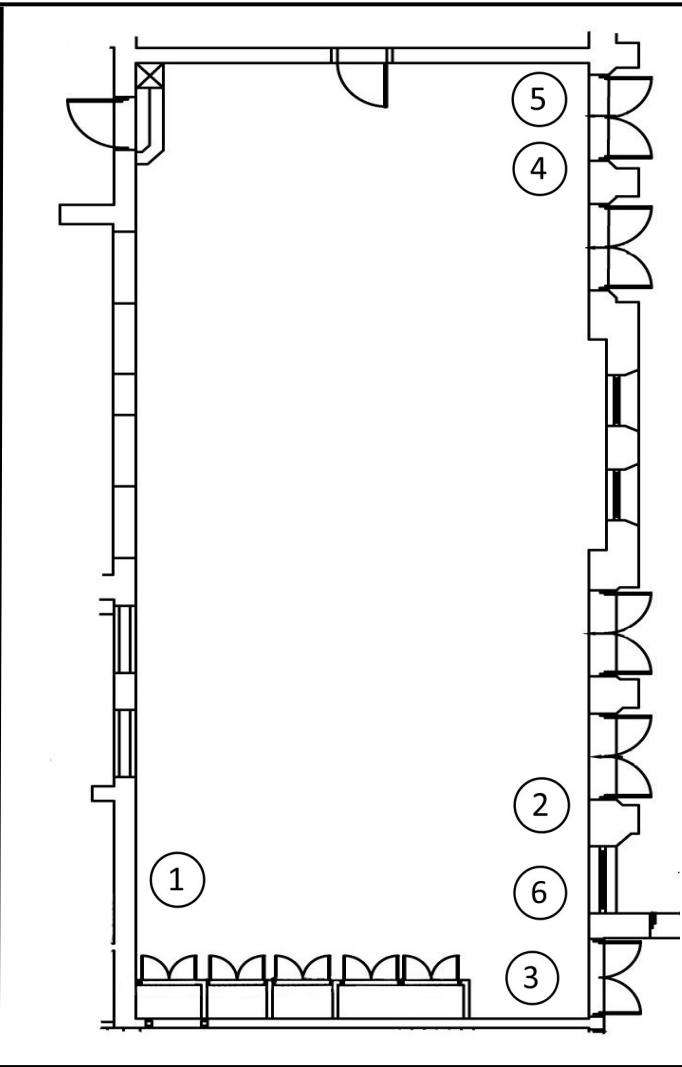

Dimensions: 17m x 8m  
Capacity: 35

Times of use:  
Mon-Thurs 9am—10:00pm  
Fri: 8:30am—4:00pm

Fire Alarm test times:  
Weekly: Wednesday 2:30pm



1. Flat screen TV
2. Sound desk
3. Piano
4. Speaker
5. Large step ladders
6. PC

Equipment & Furniture

- Stage lamps & control**
- 3 x 1k Fresnels
  - 9 x 1k Floods
  - 5 x 500w Profiles
  - 25 x Fresnels
  - 1 x 24/48 lighting control desk
  - 1 x VDU monitor
- AV & Sound Equipment**
- 1 x LG flat screen TV
  - 1 x CD player
  - 1 x Proel sound desk
  - 1 x Desk lamp
- Showcase extras**
- 2 x Large step ladders

**Important Information.**

No food or drink is allowed anywhere in the performance spaces. Capped bottles of water are permitted.

Loud, amplified rehearsals may only take place after 5pm with the windows closed.

Only equipment on the room equipment list should be left in the room after each session. This includes staging.