

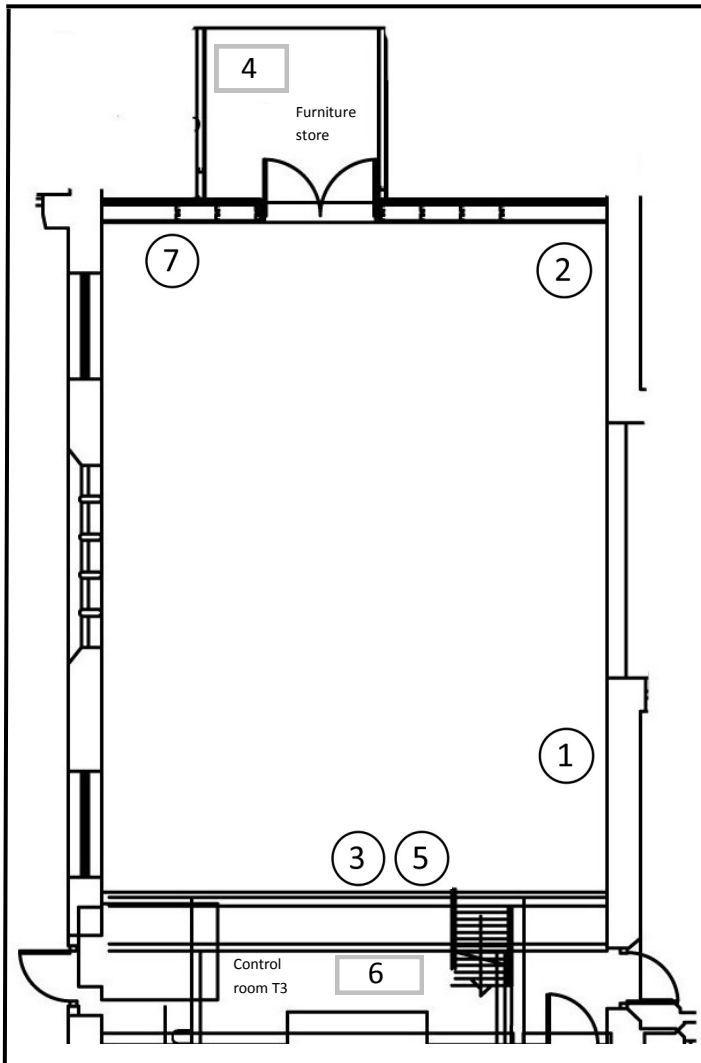

Dimensions: 12.4m x 7.6m
Capacity: 30

Times of use:
Mon-Thurs 9am—10:00pm
Fri: 8:30am—4:00pm

Fire Alarm test times:
Weekly: Wednesday 2:30pm



1. Flat screen TV
2. Ladder
3. Hand rails
4. Exam table
5. Stage blocks
6. Control room T3 kit
7. Book flats

Equipment & Furniture

- Stage lamps**
13 x 500w Fresnels.
8 x 500w Profiles.
7 x 1k Fresnels
1 x UV cannon
- AV Equipment**
1 x Samsung flat screen TV
- Staging & Furniture**
25 x black chairs.
9 x wooden chairs (various)
21 x 1mx1m stage blocks (various heights)
9 x handrails
1 x exam table
2 x Book flats.
2 x Ladder – Zarges A-Frame
- Control Room T3 kit**
1 x CD player
1 x DVD combi player
1 x amplifier
1 x Soundcraft sound desk
1 x VDU monitor
1 x audio monitor speaker
1 x 24/48 lighting control desk
1 x Proel sound desk

Important Information.
No food or drink is allowed anywhere in the performance spaces. Capped bottles of water are permitted.
Loud, amplified rehearsals may only take place after 5pm with the windows closed.
Only equipment on the room equipment list should be left in the room after each session. This includes staging.